

# SIGHT FLOW METERS

SPDT or Pulse Output, Visual Flow Confirmation, Brass Body



SF2-1



SF2-2

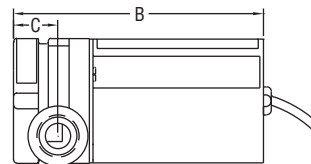
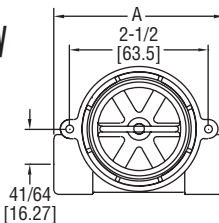

Side View VAC Switch Models

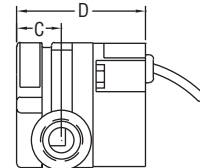

Side View VDC Switch and Transmitter Models

| DIMENSIONS in [mm] |                  |                  |                |                 |         |                  |                  |                |                 |
|--------------------|------------------|------------------|----------------|-----------------|---------|------------------|------------------|----------------|-----------------|
| Model              | A                | B                | C              | D               | Model   | A                | B                | C              | D               |
| SF2-104            | 3-1/64 [76.6]    | -                | 7/8 [22.23]    | 2-21/64 [59.13] | SF2-134 | 3-61/64 [100.41] | -                | 1-1/16 [26.99] | 2-61/64 [75]    |
| SF2-101            | 3-1/64 [76.6]    | 4-1/2 [114.3]    | 7/8 [22.23]    | -               | SF2-131 | 3-61/64 [100.41] | 4-49/64 [121.05] | 1-1/16 [26.99] | -               |
| SF2-114            | 3-1/64 [76.6]    | -                | 7/8 [22.23]    | 2-21/64 [59.13] | SF2-204 | 3-1/64 [76.6]    | -                | 13/16 [20.64]  | 2-21/64 [59.13] |
| SF2-111            | 3-1/64 [76.6]    | 4-1/2 [114.3]    | 7/8 [22.23]    | -               | SF2-214 | 3-1/64 [76.6]    | -                | 13/16 [20.64]  | 2-21/64 [59.13] |
| SF2-124            | 3-61/64 [100.41] | -                | 1-1/16 [26.99] | 2-61/64 [75]    | SF2-224 | 3-61/64 [100.41] | -                | 1-1/16 [26.99] | 2-61/64 [75]    |
| SF2-121            | 3-61/64 [100.41] | 4-49/64 [121.05] | 1-1/16 [26.99] | -               | SF2-234 | 3-61/64 [100.41] | -                | 1-1/16 [26.99] | 2-61/64 [75]    |

The **SERIES SF2** Sight Flow Transmitters combine visual confirmation of flow with a relay or pulse output. The SF2-1 offers a SPDT relay output and the SF2-2 offers a pulse output proportional to the rate of flow. The 4.5 to 24 VDC pulse output is compatible with most digital logic families.

## FEATURES/BENEFITS

- Brass, solid body construction, one piece composite rotor, and ceramic shaft delivers durability with broader chemical, temperature, and pressure capabilities
- Set points are fully adjustable over the specified flow range
- The dynamic operation of the rotor guards against jamming and false actuation

## APPLICATIONS

- Cooling and lubrication circuits
- HVAC systems
- Aggressive chemical metering
- Batching systems

| MODEL CHART - PULSED OUTPUT |             |               |                 |
|-----------------------------|-------------|---------------|-----------------|
| Model                       | Range (GPM) | Power         | Connection      |
| SF2-204                     | 0.5 to 5.0  | 4.5 to 24 VDC | 1/4" female NPT |
| SF2-214                     | 4.0 to 20.0 | 4.5 to 24 VDC | 1/2" female NPT |
| SF2-224                     | 5.0 to 30.0 | 4.5 to 24 VDC | 3/4" female NPT |
| SF2-234                     | 8.0 to 60.0 | 4.5 to 24 VDC | 1" female NPT   |

## SPECIFICATIONS

**Service:** Liquids compatible with wetted parts.

**Wetted Materials:** Brass body, ceramic pin, PPS rotor, Polysulfone lens and fluor elastomer O-ring.

**Accuracy:** Relay output:  $\pm 5\%$ ; Pulsed output:  $\pm 7\%$  for ranges up to 5.0 GPM,  $\pm 15\%$  for ranges up to 60.0 GPM.

**Temperature Limits:** -20 to 212°F (-29 to 100°C).

**Pressure Limit:** 200 psig (13.8 bar) @ 70°F.

**Power Requirements:** See table.

**Output:** SPDT: 1 Amp, 24 VDC resistive; 0.3 Amp, 110 VAC or 4.5 VDC to 24 VDC pulse depending on model.

**Electrical Connections:** Relay output models: 20AWG PVC-jacketed, 24" cable; Pulsed output models: 22AWG PVC-jacketed, 24" cable.

**Process Connections:** See table.

**Set Point Differential:** 15% max for relay output models.

**Maximum Viscosity:** 200 SSU.

**Agency Approvals:** CE.

## MODEL CHART - SPDT RELAY OUTPUT

| Model   | Range (GPM) | Power   | Connection      |
|---------|-------------|---------|-----------------|
| SF2-104 | 0.5 to 5.0  | 24 VDC  | 1/4" female NPT |
| SF2-101 | 0.5 to 5.0  | 110 VAC | 1/4" female NPT |
| SF2-114 | 4.0 to 20.0 | 24 VDC  | 1/2" female NPT |
| SF2-111 | 4.0 to 20.0 | 110 VAC | 1/2" female NPT |
| SF2-124 | 5.0 to 30.0 | 24 VDC  | 3/4" female NPT |
| SF2-121 | 5.0 to 30.0 | 110 VAC | 3/4" female NPT |
| SF2-134 | 8.0 to 60.0 | 24 VDC  | 1" female NPT   |
| SF2-131 | 8.0 to 60.0 | 110 VAC | 1" female NPT   |