

# *D20 Compact Digital Positioner*

Product  
Information





## ***D20 Compact Digital Positioner***

### ***Description***

D20 is a compact digital positioner that is very simple and quick to install and operate. To calibrate it, simply press the button for 5 seconds, D20 will auto-calibrate and tune itself in a few seconds.

D20 can be fitted with optional 4-20 mA feedback transmitter and limit switches. HART communication is also possible as an option.

For visual indication you can select between flat arrow indicator or a dome indicator.

### ***Features and Benefit***

- Modular
- Flexible
- Rotary and Linear
- Add in switch and position feedback
- VDI/VDE 3845
- VDI/VDE 3847
- HART option
- 4-20mA feedback option

#### **Intrinsically safe:**

ATEX II 1 G  Ex ia IIC T6

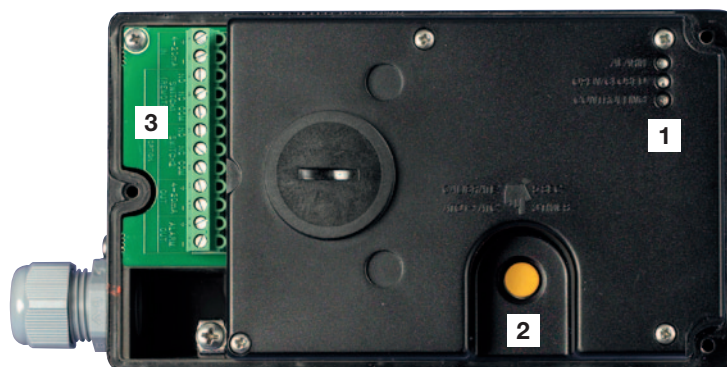

1. LED's indication
2. Calibration/configuration button
3. Add in feedback option

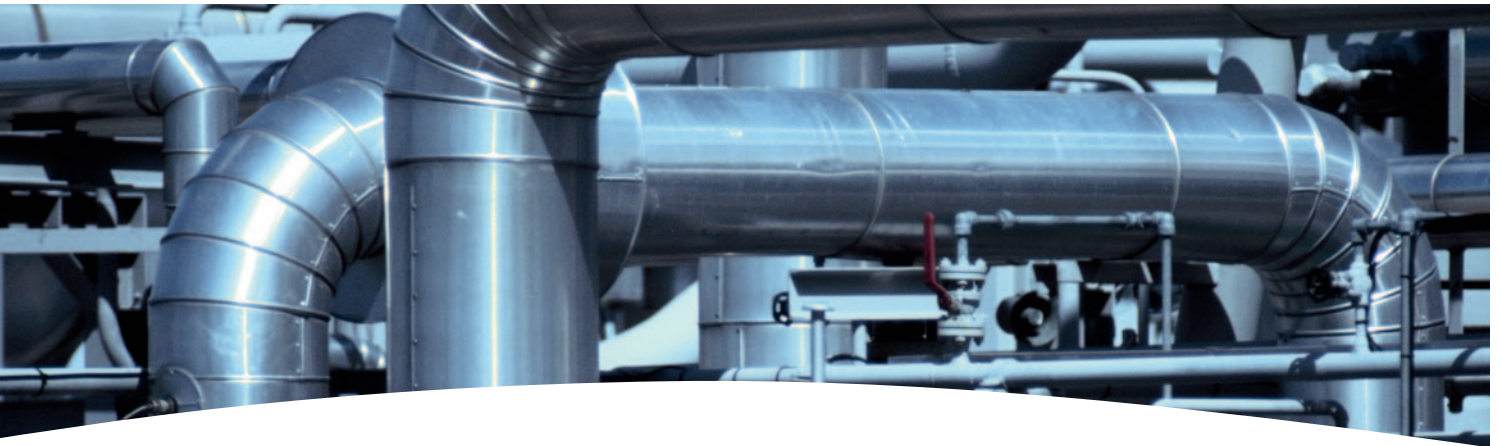

Press button and D20 will auto calibrate itself.



D20 modular design gives you many options.



D20 mounted according to VDI/VDE 3847.



D20 suits both rotary and linear actuators.

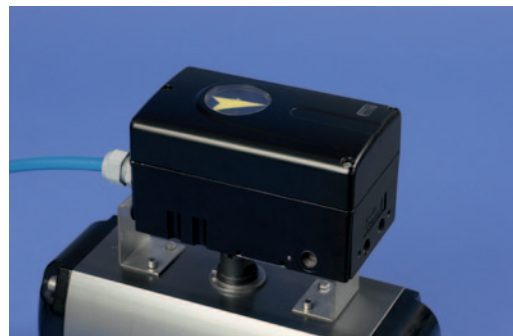

D20 mounted according to VDI/VDE 3845.

## D20 Technical data

### D20 Compact Digital Positioner

Input signal	4-20 mA
Current supply min.	3,6 mA
Current supply Max.	150 mA
Load Standard	400 ohm at 20mA
Load HART	470 ohm at 20mA
Voltage drop Standard	8 VDC at 20mA
Voltage drop HART	9.4 VDC at 20mA
Angle of rotation min	0-40°
Angle of rotation Max	0-90°
Air supply range	1.5 – 6 bar
Out put	0-100% of air supply pressure
Air supply quality	Free from oil, dust and moisture IEC 770, ISA 7.0.01
Air supply effect	<0.1%FS for 10% pressure change at 6Bar
Ingress protection	IP66 / Nema 4X
Operating humidity	0-100% rh non-condensing
Air connections	¼" NPT
Cable entry	2 x ½" or 2 x M20x 1,5
Terminals	Screw terminals 2,5 mm2 (AWG 14)
Operating Temperature	-20 to +85°C 40 to +85°C (optional)
Storage temperature	-40 to +85°C
Air delivery capacity	7 Nm3/h @ 6 bar (3 bar diff pressure)
Air delivery capacity Double acting	7 Nm3/h @ 6 bar (3 bar diff pressure)
Air consumption Single acting	0,120 Nm3/h @ 6 bar
Air consumption Double acting	0,120 Nm3/h @ 6 bar
Cv air delivery Single acting	0,12
Cv air delivery Double acting	0,12
Cut off function	Close 0.5% Open 99.5%
Linearity	<1%
Sensitivity	<0.05%
Resolution	<0,1%
Repeatability	<0.2%
Hysteresis + dead band	<0.5%
Temp effect	<0.1%/10K
Mounting position effect	<0,2%
CE	93/68/EEC, 2004/108/EEC, 2006/95/EEC
Approvals	II 1G Ex ia IIC T4 Ta:85°C
Certificate nr	Nemko 08ATEX1362X
Housing material	Die cast Aluminium
Surface treatment	Powder coating
Soft goods	Nitrile
Weight	1,5 kg

### Optional plug in module

<b>Mechanical switches</b>	
Type	SPDT
Size	Sub Sub miniature
Rating	3A, 125 VAC / 2A, 30VDC
Mechanical life	>1 x 106 operations
<b>Namur sensors</b>	
Type	P+F NJ2 V3 N Inductive DIN 19234
Load current	<1mA>3mA
Voltage range	5-25 VDC
Hysteresis	3-15% (5% typical)
Temp range	-25° to +100° C (-248° to 373° F)
<b>Namur sensors</b>	
Type	P+F SJ2-N
Normal Voltage	8 VDC
Load current	1mA<l<3mA
Voltage range	(5-25 VDC)
Hysteresis (max)	0.2%
Temp range	-25° to +100° C (-248° to 373° F)
<b>Namur sensors</b>	
Type	P+F SJ2-SN
Normal Voltage	8 VDC
Load current	1mA<l<3mA
Voltage range	5-25 VDC
Hysteresis (max)	(0.2%)
Temp range	-40° to +100° C (-233° to 373° F)
<b>Namur sensors</b>	
Type	P+F SJ2-S1N
Normal Voltage	8 VDC
Load current	1mA<l<3mA
Voltage range	5-25 VDC
Hysteresis (max)	0.2%
Temp range	-25° to +100° C (-248° to 373° F)
<b>Proximity switches</b>	
Type	SPDT
Rating	10W
Voltage max	200VDC
Current max	500mA
Contact resistance max	0.2 ohm
Operating time	1.0 ms
<b>Transmitter</b>	
Power supply	12-28 VDC
Output	1-22 mA
Resolution	0.1%
Linearity	±0.5%
Load impedance	600 ohm at (12 VDC and 20mA)
<b>Alarm Output</b>	
Supply	3-28 VDC
Output	20mA @ 24 VDC



### Spindles and Dimensions drawings (mm)

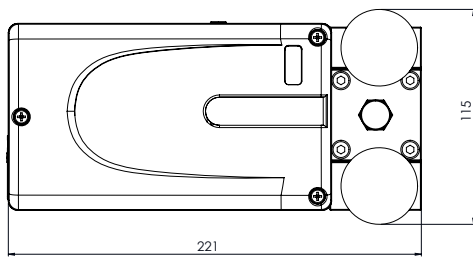

Double acting block

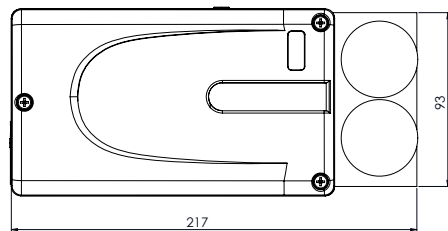

Gauge block

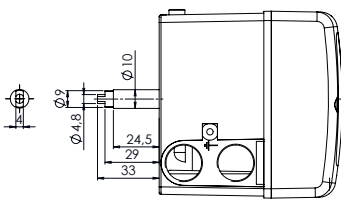

S23 "Namur Spindle"

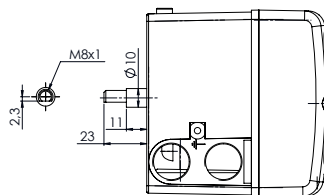

S39 "D Spindle"

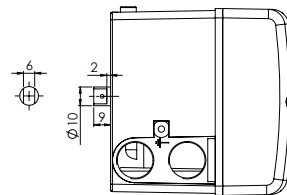

S09 "Double D Spindle"

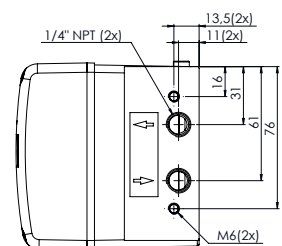
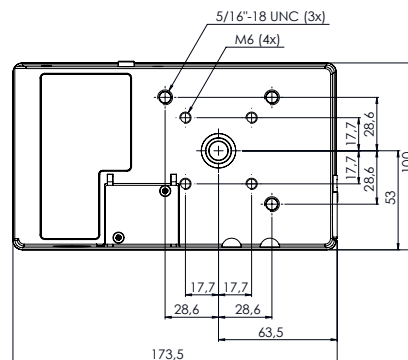
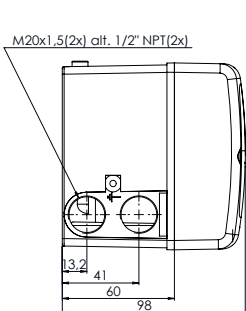



## **D20 Compact Digital Positioner Model Code**

- A = Model no**  
D20 Digital compact positioner, General purpose, LED status
- B = Approval, Certificate**  
D General purpose version  
I Intrinsically safe version ATEX
- C = Connections Air, Electrical**  
M 1/4" NPT air, M20 x 1,5 electrical x 2  
N 1/4" NPT air, 1/2" NPT electrical x 2
- D = Housing/Surface treatment**  
U Aluminium/Powder epoxy, black
- E = Function**  
S Single acting  
D Double acting, incl gauges (2) Stainless/Brass
- F = Mounting options / Spindle**  
09 Double D type, adaptor spindle  
12 Flowtop, D-style+ nut, direct mounting, Kit 30144 include  
23 VDI/VDE 3845 rotary, Mounting kit not included  
39 IEC 534-6, Flat D type, nut incl. Mounting kit not included  
40 VDI/VDE 3847 Linear, Flat D, Mounting kit 30145 included
- G = Cover and Indicator**  
PVA PMV, Black cover, Arrow indicator  
PVB PMV, Black cover, No indicator  
PVD PMV, Black cover, Dome indicator
- H = Temperature/seals**  
Z Standard -20°C to 85°C (-4°F to 185°F)  
Q Low temp -40°C to 85°C (-38°F to 185°F)
- I = Input signal/Protocol**  
4 4-20 mA / none  
5 4-20 mA / HART
- J = Feedback option, 4-20 mA transmitter, switches**  
X No feedback option  
T 4-20 mA transmitter only  
S Limit switches Mechanical SPDT + 4-20mA  
N Namur V3 type sensor, P+F NJ2-V3-N + 4-20mA  
P Limit switches Proximity SPDT + 4-20mA  
4 Slot type Namur sensor, P+F SJ2-S1N + 4-20mA  
5 Slot type Namur sensor, P+F SJ2-SN + 4-20mA  
6 Slot type Namur sensor, P+F SJ2-N + 4-20mA
- K = Options, Add in electronics**  
0 Standard diagnostics
- L = Accessories**  
X No accessories  
M Gauge block 1/8" G (2 x gauges included)  
N Gauge block 1/8" NPT (2 x gauges included)

**Example: AAABCD-EFFGGG-HIJKL**



p/n: FCD PMENBR0015-01



Hazardous Locations 08ATEX 1362X

II 1 G Ex ia IIC T4 Ta: 85°C

Flowserve Corporation has established industry leadership in the design and manufacture of its products. When properly selected, this Flowserve product is designed to perform its intended function safely during its useful life. However, the purchaser or user of Flowserve products should be aware that Flowserve products might be used in numerous applications under a wide variety of industrial service conditions. Although Flowserve can (and often does) provide general guidelines, it cannot provide specific data and warnings for all possible applications. The purchaser/user must therefore assume the ultimate responsibility for the proper sizing and selection, installation, operation, and maintenance of Flowserve products. The purchaser/user should read and understand the Installation and Maintenance (I & M) instructions included with the product, and train its employees and contractors in the safe use of Flowserve products in connection with the specific application.

While the information and specifications contained in this literature are believed to be accurate, they are supplied for informative purposes only and should not be considered certified or as a guarantee of satisfactory results by reliance thereon. Nothing contained herein is to be construed as a warranty or guarantee, express or implied, regarding any matter with respect to this product. Because Flowserve is continually improving and upgrading its product design, the specifications, dimensions and information contained herein are subject to change without notice. Should any question arise concerning these provisions, the purchaser/user should contact Flowserve Corporation at any one of its worldwide operations or offices.

©2008 Flowserve Corporation, Irving, Texas, USA. Flowserve and PMV are registered trademarks of Flowserve Corporation.

**Palmstierna International AB**

Korta Gatan 9  
SE-171 54 Solna  
SWEDEN  
Tel: +46 (0) 8 555 106 00  
Fax: +46 (0) 8 555 106 01  
E-mail: infopmv@flowserve.com

**Germany**

Flowserve  
Sperberweg 16  
D-41468 Neuss  
GERMANY  
Tel: +49 (0) 2131 795 74 80  
Fax: +49 (0) 2131 795 74 99  
E-mail: pmvgermany@flowserve.com

**UK**

Flowserve  
Abex Road  
Newbury, Berkshire, RG14 5EY  
UK  
Tel: +44 (0) 1635 46 999  
Fax: +44 (0) 1635 36 034  
E-mail: pmvukinfo@flowserve.com

**Italy**

Flowserve Spa  
Via Prealpi, 30  
20032 Cormano (Milano)  
ITALY  
Tel: +39 (0) 2 663 251  
Fax: +39 (0) 2 615 18 63  
E-mail: infoitaly@flowserve.com

**USA, Mexico**

PMV-USA  
1440 Lake Front Circle, Unit 160  
The Woodlands, TX 77380  
USA  
Tel: +1 281 292 7500  
Fax: +1 281 292 7760  
E-mail: pmvusa@flowserve.com

**Canada**

Cancoppas Limited  
2595 Dunwin Drive, Unit 2  
Mississauga, Ont L5L 3N9  
CANADA  
Tel: +1 905 569 6246  
Fax: +1 905 569 6244  
E-mail: controls@cancoppas.com

**Asia Pacific Headquarters**

Flowserve Pte Ltd.  
No. 12 Tuas Avenue 20  
REPUBLIC OF SINGAPORE 638824  
Tel: +65 (0) 687 98900  
Fax: +65 (0) 686 24940  
E-mail: fcdasiaprocess@flowserve.com

**South Africa**

Flowserve  
Unit 1, 12 Director Road  
Spartan Ext. 2  
1613 Kempton Park, Gauteng  
SOUTH AFRICA  
Tel: +27 (0) 11 397 3150  
Fax: +27 (0) 11 397 5300

**The Netherlands**

Fabromatic BV  
Rechtzaad 17  
4703 RC Roosendaal  
THE NETHERLANDS  
Tel: +31 (0) 30 6771946  
Fax: +27 (0) 30 6772471  
E-mail: fcbinfo@flowserve.com

**China**

Flowserve  
Hanwei Building  
No. 7 Guanghua Road  
Chao Yang District  
100004 Beijing  
CHINA  
Tel: +86 (10) 6561 1900  
Fax: +86 (10) 6561 1899

[www.pmv.nu](http://www.pmv.nu)